



DIAMONDBACK

DiamondBackCovers.com / 800 935 4002

HD CAB GUARD

INSTALLATION GUIDE

AX-5

30 minutes
Normal install time

Keep an eye out for these icons:

IMPORTANT!
Important installation information

Helpful Hints
Tips to assist installation

PARTS INCLUDED:

Frame

Gussets (2)

TOOLS REQUIRED:

Marker	Drill	5/16" Bit	Ratchet Wrench	1/2" Socket	3/16" Hex Key

ASSEMBLE THE GUARD

1 Affix one of the strips of **gasket tape** to the underside of each gusset bolt flange, covering the pre-drilled hole.

2 Attach a **gusset** to the **frame** by inserting a 2" bolt through the hole at the bottom corner of the outside face of the gusset and into the hole at the bottom of the side of the frame.

Make sure to orient the frame so that the dog ears are up and the **mesh is facing the tailgate**.

3 Put a lock washer and stainless nut onto the bolt. Hand-tighten only.

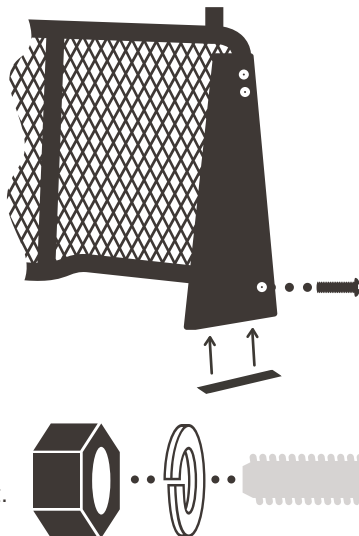

4 Attach a **cleat** to the cab guard by inserting a pair of 3" bolts through the holes in the cleat, through the holes at the top of the gusset, and into the holes toward the top of the side of the frame.

5 Put a lock washer and stainless nut onto each cleat bolt. Hand-tighten only.

6 Repeat steps 2-5 on the opposite side of the frame, then tighten all the bolts with a 1/2" socket & 3/16" hex key.

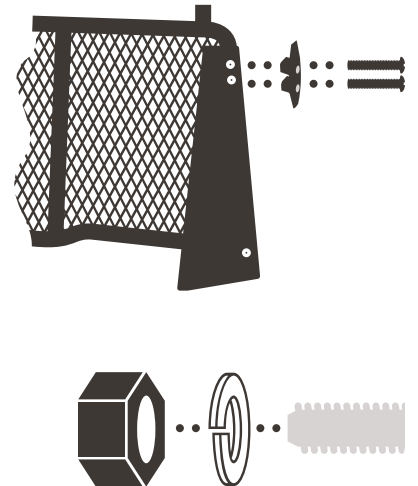

INSERT THE FIRST TWO MOUNTING BOLTS

- 7 Remove the cab panel of the cover. Place it on a table or other flat surface.
- ★ Installing the cab guard is easiest if you let the sides of the panel hang over the table to allow access to the underside for drilling and bolting.
- 8 Poke a hole through the gasket tape where it passes under the pre-drilled hole in each gusset bolt flange.

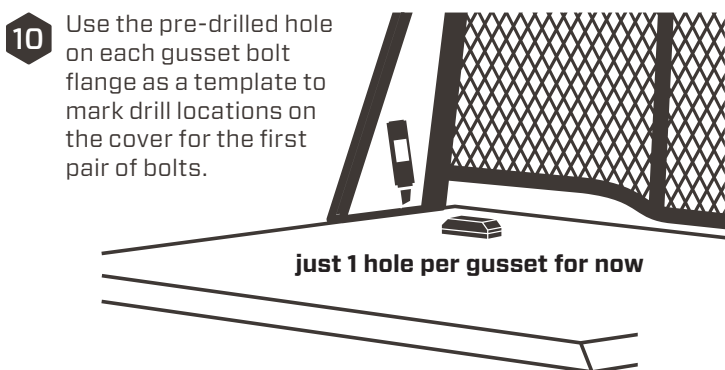
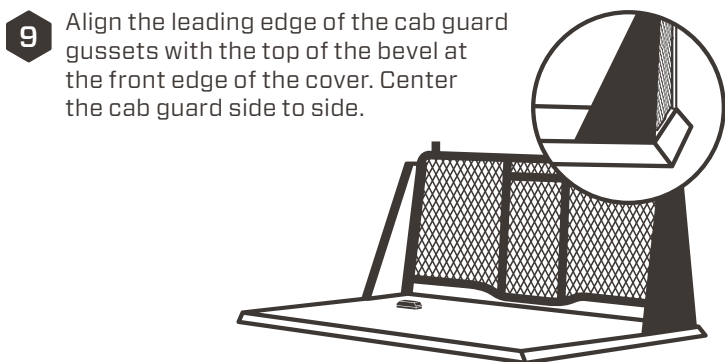

- 11 Double-check the underside of the cover to verify that nothing will obstruct the bolts or washers at these locations. Adjust the locations of the bolt holes if necessary.

- 12 Set the cab guard aside. Drill the marks using a 5/16" bit.

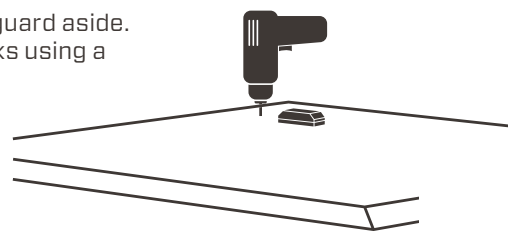

- 13 Place the cab guard back onto the cover. Drop a 1" bolt through a stainless flat washer and foam washer, then into each flange hole, then into the cover.

- 14 Put a fender washer, stainless flat washer, and lock nut, in that order, onto each bolt.

- 15 Tighten the lock nuts with a 1/2" socket and a 3/16" hex key.

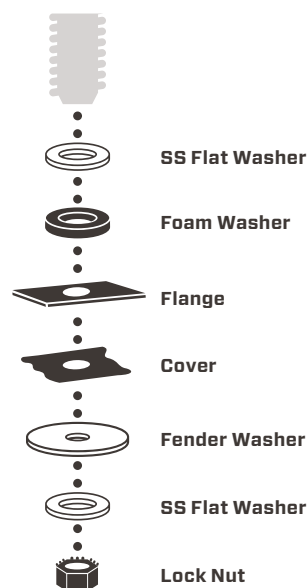

INSERT THE SECOND TWO MOUNTING BOLTS

- 16 Keep the gussets aligned with the top of the bevels of the cover as you use a 5/16" bit to drill bolt holes up through the cover and gusset flanges at the two 'x' marks labeled 'C' on the underside of the cover.

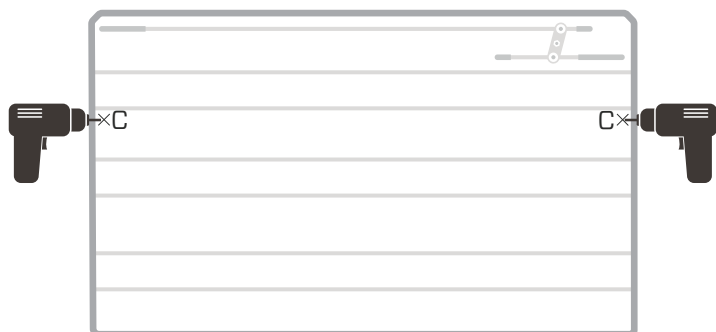

- 17 Repeat steps 12-14 for the new holes.

- 18 Use a 1/2" socket and 3/16" hex key to tighten all the bolts holding the gussets to the frame.

- 19 Re-attach the cab panel to the rest of the cover.

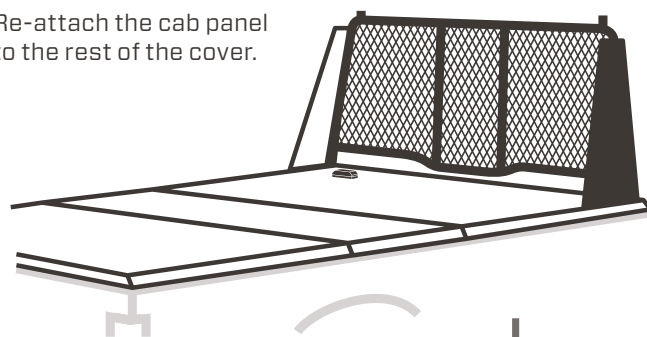

- ! To avoid hinge damage, make sure to fully mate the hinges before bringing the cab panel back into its closed position.

