



DIAMONDBACK

BED PREP KIT

'19-UP GMC SIERRA 1500
W/ CARBON PRO BED



Install Video

INSTALLATION GUIDE

MISC-29

40 minutes
Normal install time

Keep an eye out for these icons:

IMPORTANT!
Important installation information

★ Helpful Hints
Tips to assist installation

PARTS INCLUDED:

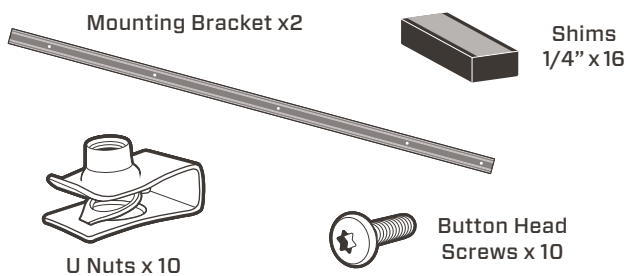

TOOLS REQUIRED:



PRE-INSTALLATION NOTE

(REVIEW ALL OTHER INCLUDED INSTALLATION GUIDES BEFORE BEGINNING)

To ensure all adhesives adhere properly, make sure the ambient temperature is at least 50°F and will remain so for at least a day.



50°F min.

MARK AND REMOVE THE BED RAIL CAPS

- Before removing the bed caps, mock up the provided mounting bracket to mark holes on the plastic bed cap. Have a helper hold the mounting bracket flush with the top of the bed cap and tight against the bulkhead.

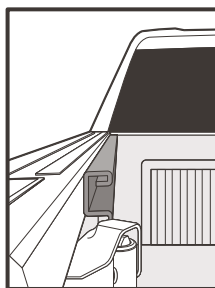

The Mounting Brackets have stickers affixed to them identifying which side of the truck they should be mounted on, as well as the direction they should be facing. Take time to familiarize yourself with their location and direction as this step is critical to the success of the cover install.

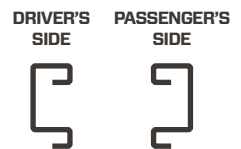

! The included Driver and Passenger side images show how the mounting brackets should appear when viewed from the tailgate of the truck looking forward.

- Mark all 5 holes, being sure to pay special attention to the orientation of the mounting bracket, both up and down direction, as well as driver and passenger side. Repeat on passenger's side with passenger's side mounting bracket. Set mounting brackets aside for later use.

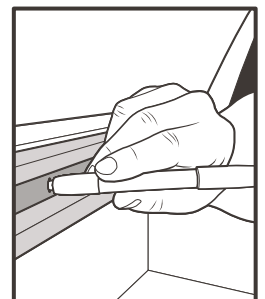
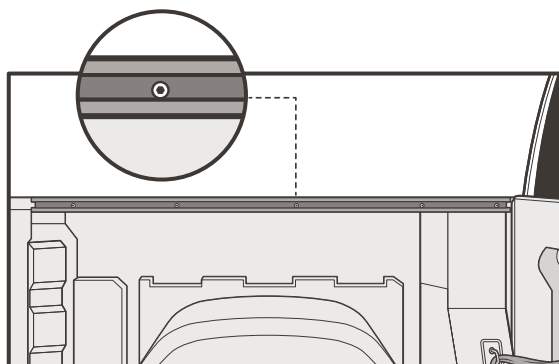

MARK AND REMOVE THE BED RAIL CAPS (CONTINUED)

- 3 To remove the bed rail cap, start at the front of the bed near the cab on either side. Using your fingers, grasp onto the bed rail cap on the inside and pull directly up.

! Be careful not to bend or crease the bed rail cap. Stay as close to the clip that you are trying to release as possible.

NOTE: Multiple clips may be released at one time during this process.

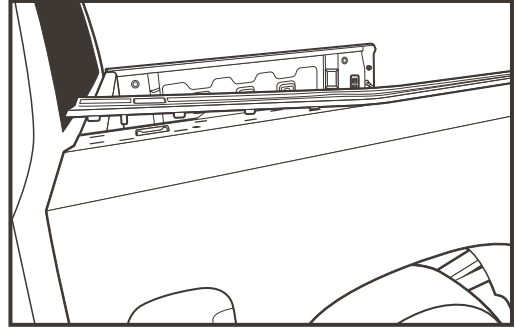

- 4 Continue using upward force as you work away from the cab, clips will continue to release.

- 5 Continue working towards the tail of the truck until you have completely removed one of the bed rail caps from the truck.

- 6 Repeat steps 1-4 on the other side.

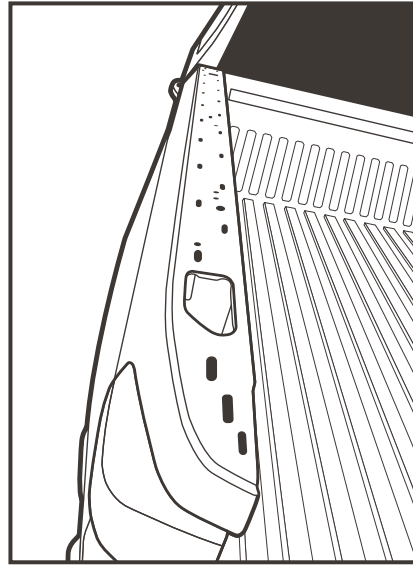

PREPARE THE BED SIDES

- 7 Using a center punch, mark the center of the holes from step 2 on the bed rail caps.

- 8 Use an 1/8" pilot drill bit to drill out the holes. Then, use a 1/2" drill bit to size the holes appropriately.

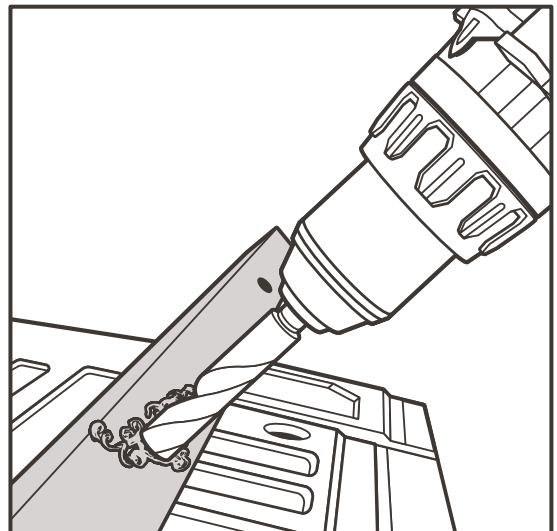

PREPARE THE BED SIDES (CONTINUED)

9

Using the T-30 Torx Bit and ratchet wrench, remove the 2 middle fasteners on each metal bed lip. This will allow the metal bed rail to be pulled up to install shims.

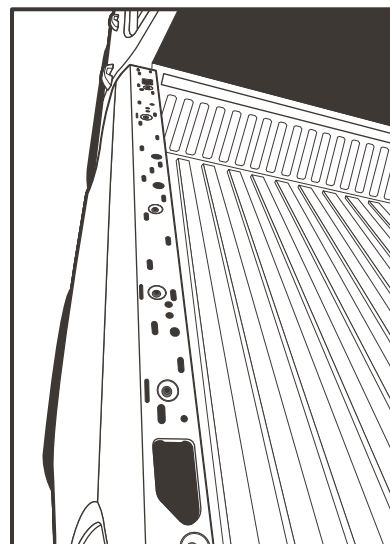
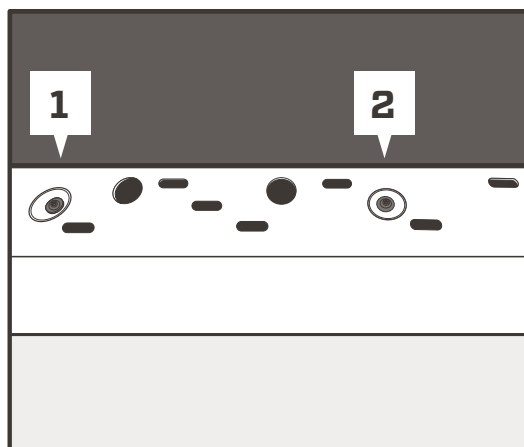

10

Install 4 shims, per side, between carbon bed lip and metal bed rail, as seen in illustrations below:

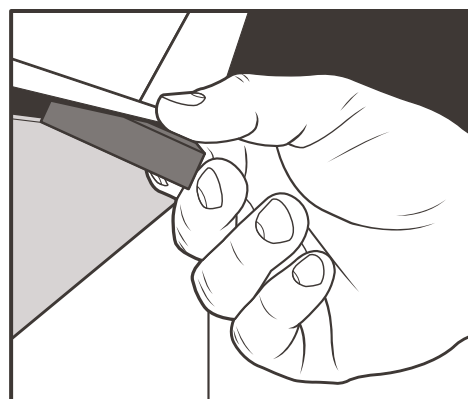
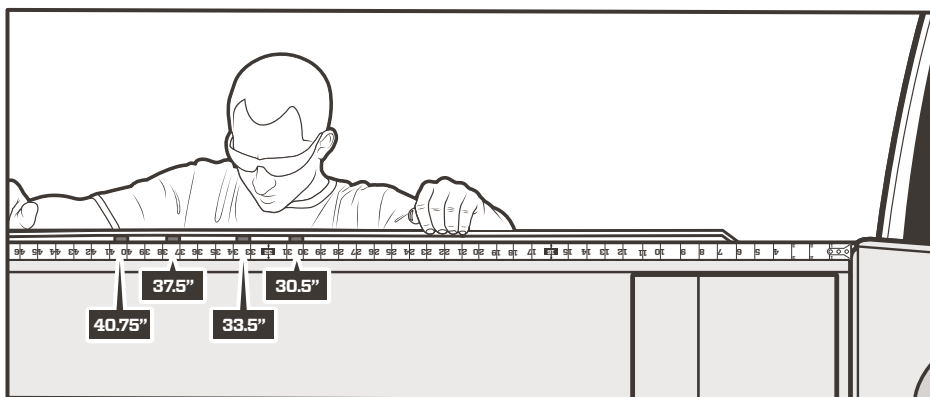

11

Re-install the two middle fasteners of each metal bed rail lip using the T-30 Torx Bit and Ratchet Wrench.

12

Install U nuts in the carbon bed lip based on the illustration below:

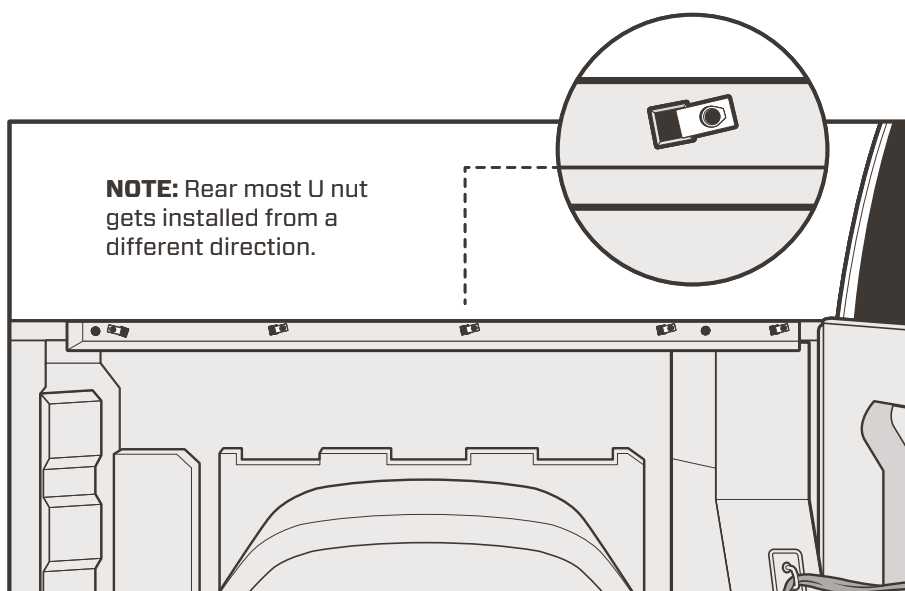
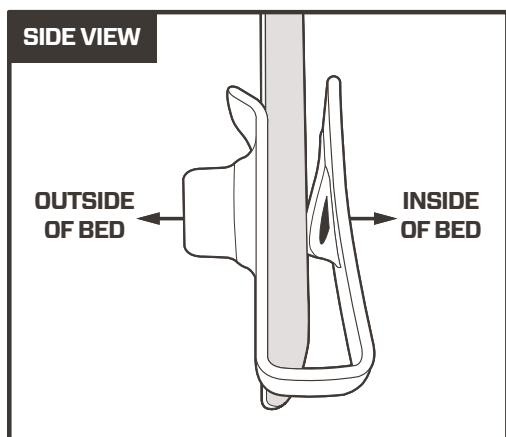

BED RAIL CAP SHIM INSTALLATION

- 13 You will need to clean the underside of the bed rail caps. We recommend alcohol and a lint free cloth to remove any contaminants or dirt. Allow them to dry.
- 14 Each bed rail cap will require 4 shims. Using the illustration as a guide, test fit the shims in the shown locations on the underside of the bed rail caps. They will all be towards the inside of the bed rail cap.
 - ★ During placement it can be helpful to set the shims with the adhesive backing up to confirm placement before removing tape. Shims may need to be trimmed with scissors to fit appropriately.
- 15 Peel and place the shims at the locations determined during the previous step. Be sure to press firmly along the entire shim to ensure adhesion.
- 16 Install the bed rail cap by starting at the tail. Make sure the clips and locating pins are aligned and begin pressing them back into the slots by applying downward pressure and working towards the cab.
- 17 Repeat this process on the other side.

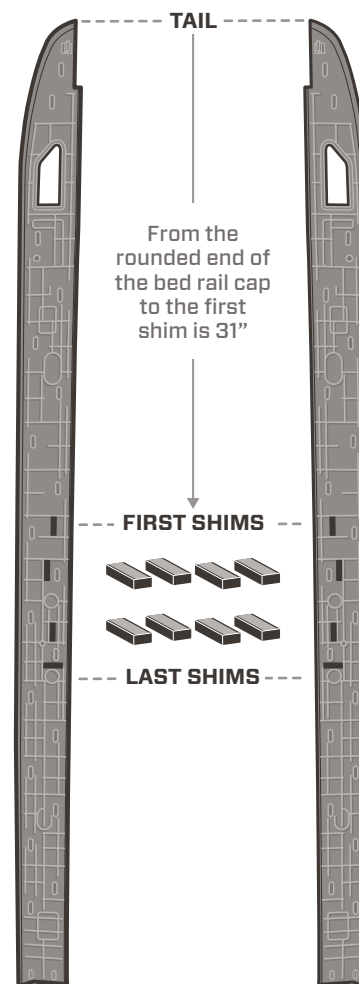

AFFIX THE MOUNTING BRACKET

- 18 Locate the mounting bracket listed for the driver side. Install the mounting bracket loosely using the button head screws. Once all screws are installed, fully tighten hardware. Using a T-30 Torx bit, install the mounting bracket using the button head screws.

! Ensure you are using the correct mounting bracket for the correct truck bed side.

! Be careful not to over tighten.

Repeat this process on the other side.

NOTE: This completes the bed prep kit for the GMC Sierra CarbonPro Bed. You may now continue with installation of your DiamondBack cover. Please continue with the Bulkhead Prep Kit before starting the installation of your DiamondBack cover.

