

INSTALLATION GUIDE

45 minutes
Normal Install Time

Keep an eye out for these icons:

IMPORTANT!
Important installation information

Helpful Hints
Tips to assist installation

PARTS INCLUDED:

Adapter Bars	5/16" Lock Nuts	5/16" Foam Washers	5/16" SS Washers	5/16" Fender Washers
SUBL-D: (2) 35" + (2) 23" + (2) 20"	12	12	24	12
SUBL: (2) 35" + (2) 23" + (2) 17"				
SUBS: (2) 28" + (2) 17" + (2) 8"				
SUBC: (2) 28" + (2) 17"	8	8	16	8
SUBM: (2) 20" + (2) 17"				

PRE-INSTALLATION NOTES:

1. If your **DiamondBack HD** cover is already installed, remove it and set it on the ground.
2. Do not remove the factory-installed hardware from the adapter bars.

TOOLS REQUIRED:



INSTRUCTIONS

- 1 On the ground, attach the cab and tailgate panels of the cover to the center panel by mating the hinges.
- 2 Use a 5/16" bit to drill bolt holes up through the tailgate panel at the two 'x' marks labeled 'A' on its underside near its chamfered corners.

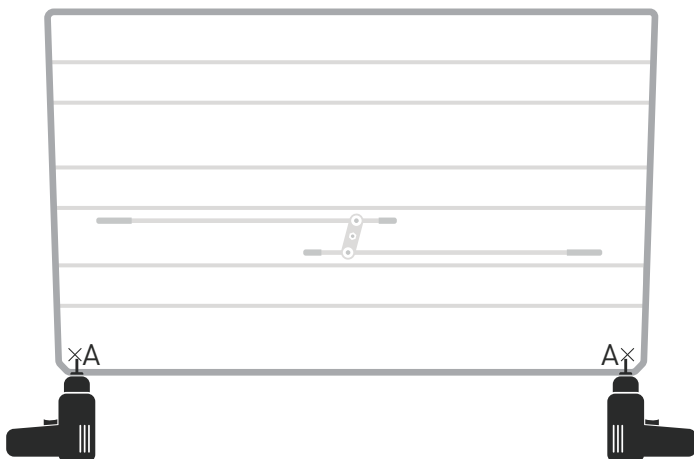

- 3 Repeat step 2 for the cab panel, but use the 'A' marks nearest its meeting point with the center panel instead.
- 4 If the gas springs are still attached to the cab and tailgate panels, detach them. Lay the panels flat.
- To avoid hinge damage, make absolutely sure the hinges are fully mated before bringing a panel back into the closed position.
- 5 Snap a chalk line along the length of the cover between each pair of holes.

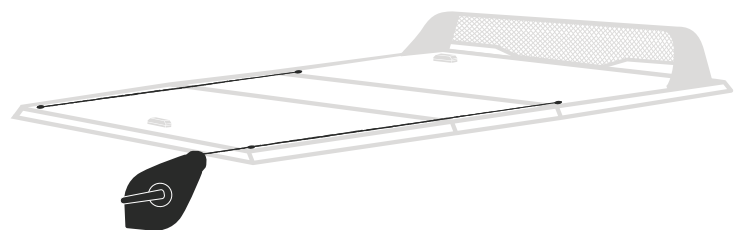
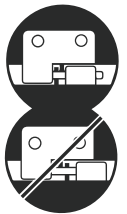

6 Take a **long adapter bar** and insert one of its bolts through a stainless washer, through a foam washer, then into the open hole on the passenger side of the tailgate panel.

7 Swivel the adapter bar so its other bolt aligns with the chalk line. Mark that intersection.

8 Drill the mark.

9 Insert the second adapter-bar bolt through a stainless washer, through a foam washer, then into the new hole.

10 Put a fender washer, stainless washer, and lock nut, in that order, onto each bolt. Tighten the lock nut using a 1/2" socket until the foam washer is fully compressed and the stainless washer above it is tight to the surface of the cover.

! Make sure there is absolutely no play in the bar when you forcefully push or pull it from above.

11 Repeat steps 6-10 on the driver side with the other long adapter bar.

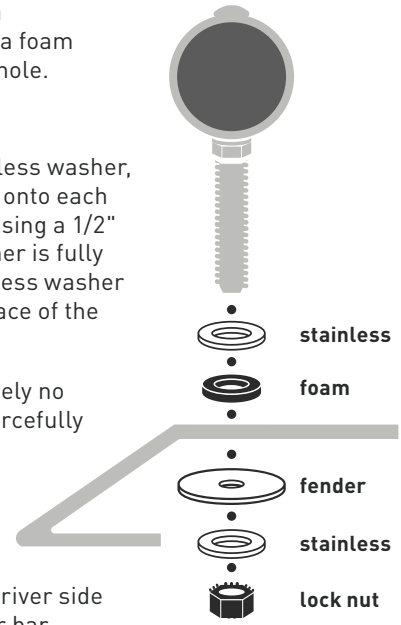
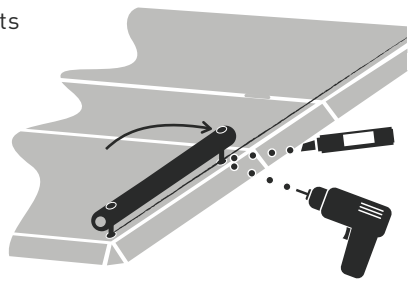

12 Repeat steps 6-11 on both sides of the cab panel with the next-longest pair of adapter bars.

13 If there are no more adapter bars to install, skip to step 18. If two more adapter bars remain, remove the cab and tailgate panels from the center panel.

14 Set one **short adapter bar** onto the center panel, centered along the panel's width, its bolts aligned with the chalk line. Mark the intersection of one of the bolts with the chalk line.

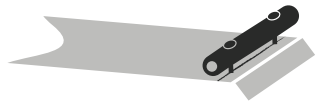

15 Double-check the underside of the cover to verify that nothing will obstruct the washers and bolts at this location. Drill the mark.

16 Repeat steps 6-10 on the center panel with this short adapter bar.

17 Repeat steps 14-16 on the other side of the center panel with the other short adapter bar.

18 Re-install the cover.

! To avoid hinge damage, make sure the hinges are fully mated before bringing the cab panel back into its closed position.

