



INSTALLATION GUIDE

MISC-30

30 minutes
Normal install time

Keep an eye out for these icons:

IMPORTANT!
Important installation information

★ Helpful Hints
Tips to assist installation

PARTS INCLUDED:

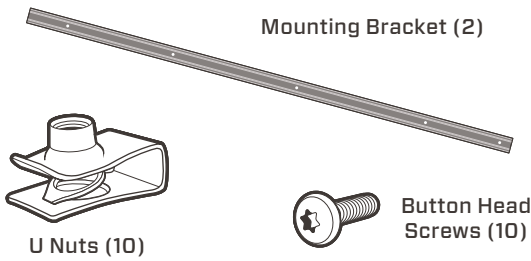

TOOLS REQUIRED:

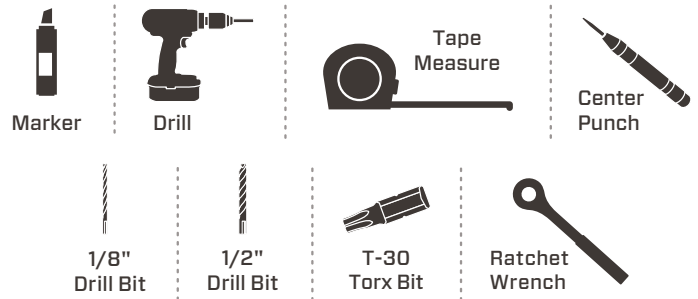

MARK THE BED RAIL CAPS

1 Before removing the bed caps, use the driver's side mounting bracket to mark holes on the corresponding plastic bed caps. Have a helper hold the mounting bracket flush with the top of the bed cap and tight against the bulkhead.

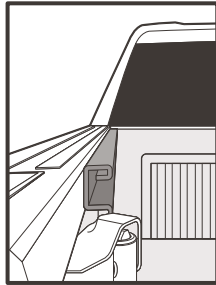

The Mounting Brackets have stickers affixed to them identifying which side of the truck they should be mounted on, as well as the direction they should be facing. Take time to familiarize yourself with their location and direction as this step is critical to the success of the cover install.

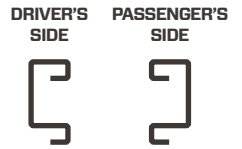

! The illustrations above show how the mounting brackets should appear when viewed from the tailgate of the truck looking forward.

2 On the driver's side, mark all 5 holes. Be sure to pay attention to the orientation of the mounting bracket, ensure it is flush with the top of the bedrail cap and tight against the bulkhead.

3 Repeat on the passenger's side with passenger's side mounting bracket. Set mounting brackets aside for later use.

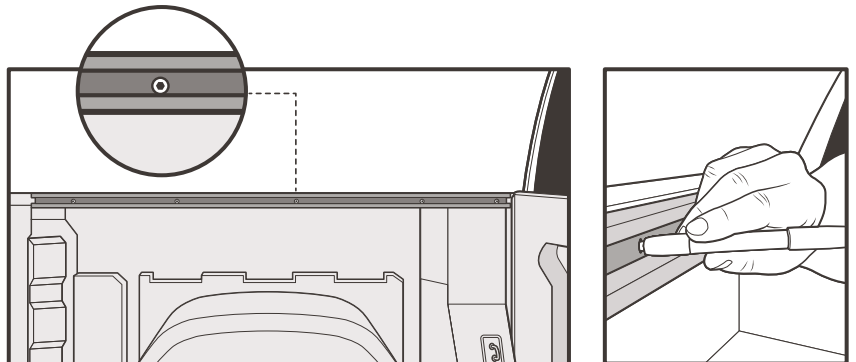

REMOVE THE BED RAIL CAPS

4 To remove the bed rail cap, start at the front of the bed near the cab on either side. Using your fingers, grasp onto the bed rail cap on the inside and pull directly up.

! Be careful not to bend or crease the bed rail cap. Stay as close to the clip that you are trying to release as possible.

NOTE: Multiple clips may be released at one time during this process.

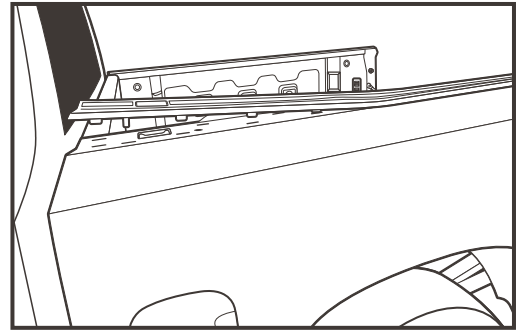

5 Continue using upward force as you work away from the cab, clips will continue to release.

6 Continue working towards the tail of the truck until you have completely removed one of the bed rail caps from the truck.

7 Repeat steps 4-6 on the other side.

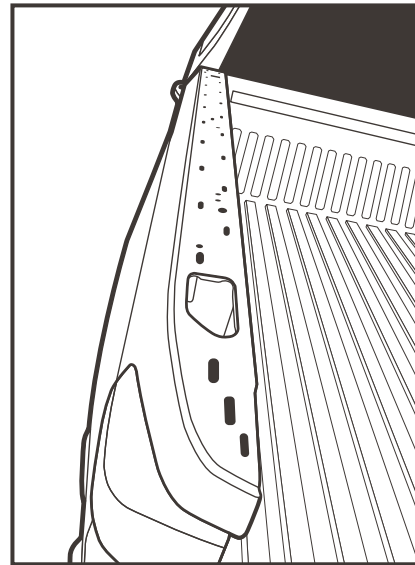

PREPARE THE BED SIDES

8 Using a center punch, punch the center of the marks from step 2 on the bed rail caps.

9 Use an 1/8" pilot drill bit to drill out pilot holes. Then, use a 1/2" drill bit to size the holes appropriately.

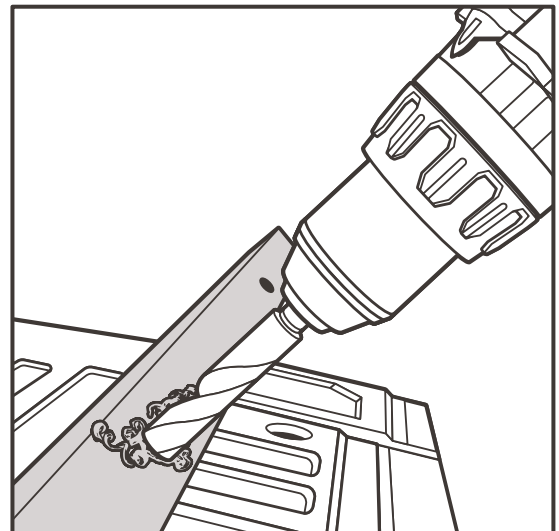

PREPARE THE BED SIDES (CONTINUED)

- 10 Install U nuts in the carbon bed lip based on the illustration below:

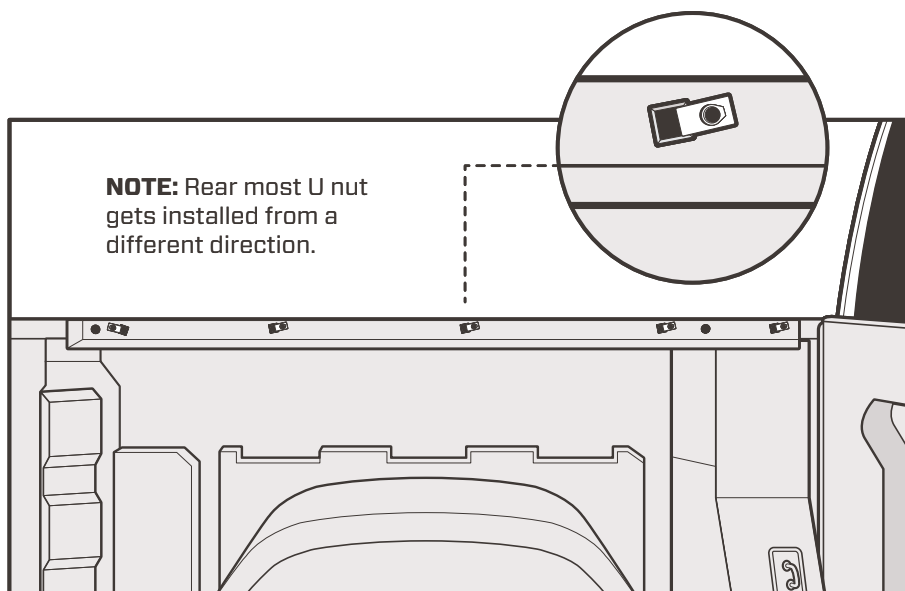
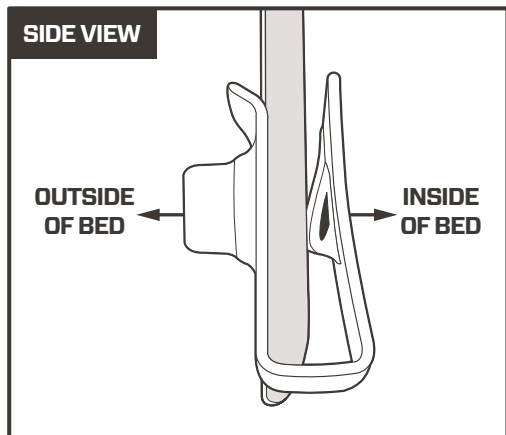

- 11 Install the bed rail cap by starting at the tail. Make sure the clips and locating pins are aligned and begin pressing them back into the slots by applying downward pressure and working towards the cab.

- 12 Repeat steps 8-11 on the other side.

AFFIX THE MOUNTING BRACKET

- 13 Locate the mounting bracket labeled for the driver side. Install the mounting bracket loosely using the button head screws. Once all screws are installed, fully tighten hardware. Using a T-30 Torx bit, install the mounting bracket using the button head screws.

! Ensure you are using the correct mounting bracket for the correct truck bed side.

! Be careful not to over tighten.

- 14 Repeat this process on the other side.

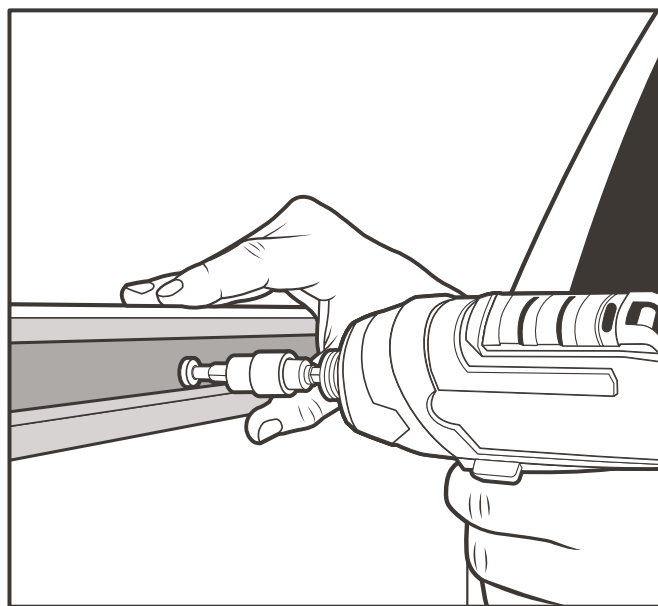

NOTE:

This completes the bed prep kit for the GMC Sierra CarbonPro Bed. You may now continue with installation of your DiamondBack cover. Please continue with the Bulkhead Prep Kit before starting the installation of your DiamondBack cover.