



**DIAMONDBACK**

DiamondBackCovers.com / 800 935 4002

# DIAMONDBACK LIGHT

## INSTALLATION GUIDE

DP-2

**5 minutes**  
Normal install time

Keep an eye out for these icons:

**IMPORTANT!**  
Important installation information

**Helpful Hints**  
Tips to assist installation

### PARTS INCLUDED:

DiamondBack Light (Qty 1)

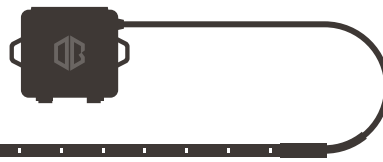

### TOOLS REQUIRED:



Rubbing Alcohol



Lint-Free Cloth

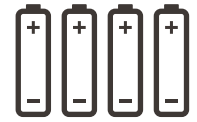

AA Batteries (Qty 4)  
Duracell Procell Recommended

### NOT INCLUDED:

### PRE-INSTALLATION NOTE:

To ensure the DiamondBack Light sticks, make sure the temperature of your mounting surface is at least 50°F and will remain so for at least a day.

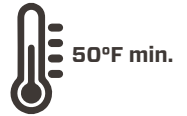

## INSTRUCTIONS

**1** Determine where you would like to mount the DiamondBack Light strip and battery box. One of our favorite locations is on the underside of the beveled edge of an access panel.

★ Mounting the battery box can be done by using either the included adhesive or the mounting tabs on the side of the box.

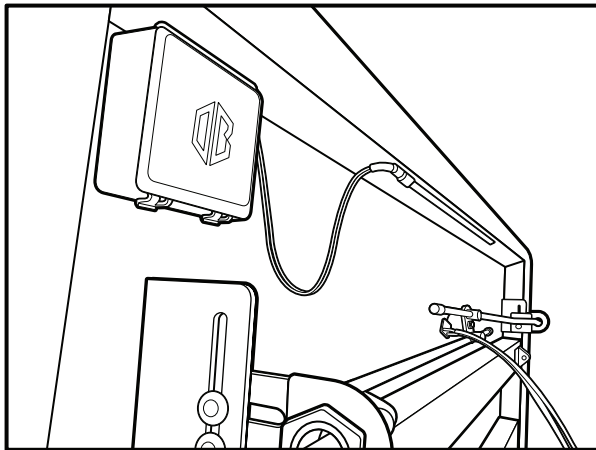

**2** The mounting location must provide access to the battery compartment. There must be room to open the tabs and swing the battery door around 90°.

**3** Clean the desired mounting surface for the light strip and battery box thoroughly with a clean, lint-free cloth and rubbing alcohol or glass cleaner. Allow to dry.

! The adhesive is not reusable and will be damaged if removal is attempted. Confirm the DiamondBack Light placement before moving to the next step.

**4** Remove adhesive liner from the light strip and adhere to the cleaned surface. Support the battery box to prevent strain on the wire harness.

**5** Confirm location of the battery box by ensuring the wire will not interfere with any moving parts on the cover or rub against any sharp edges.

! By minimizing slack in the wire, it will keep wire in place.

**6** Remove adhesive liner from the battery box and apply to the cleaned surface.

! Be sure to press down on all adhered surfaces of the light strip and battery box for a minimum of 30 seconds to ensure it adheres properly.

**7** During the first day, minimize any tugging or bumping of box and strip while the adhesive cures.

# USAGE INSTRUCTIONS

1 Install the batteries.

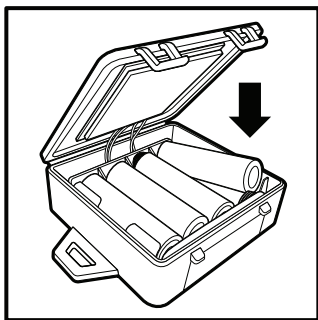

2 Wait 10 seconds for DiamondBack Light software to boot up before interacting with the DiamondBack Light.

3 To activate DiamondBack Light, place your hand on the DiamondBack logo for 1 second.

★ In an effort to conserve battery life, the DiamondBack Light software goes to sleep and waits to be activated. Any touch lag is due to this sleep mode and/or quick tapping, and is not a flaw.

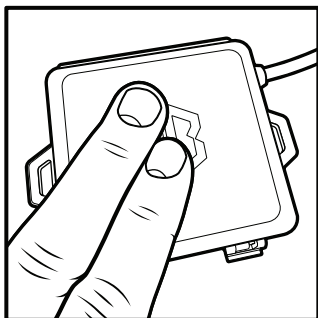

4 The DiamondBack Light will automatically turn off after 5 minutes. As this time approaches it will begin to flash. If desired, press on the DiamondBack Light again after it has begun flashing to reset the timer.

5 The DiamondBack Light can be turned off manually by placing your hand on the logo again.

★ If at any point the DiamondBack Light seems unresponsive, wait 10 seconds before interacting with the light again. This time allows the touch sensor to recalibrate.

6 Battery life is usage dependent, but DiamondBack recommends replacing your batteries every 6-9 months.

! The DiamondBack Light is water resistant, however avoid any direct sprays of water onto the DiamondBack Light strip or battery box.