

INSTALLATION GUIDE



45 minutes

Normal install time

Keep an eye out for these icons:



IMPORTANT!

Important installation information



Helpful Hints

Tips to assist installation

PARTS INCLUDED:

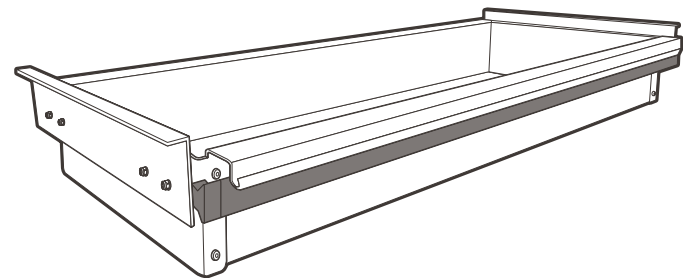



Elevator Bolts (2)



1/4" Hex Bolts (4)



1/4" Lock Washers (6)



1/4" Rivet Nuts (4)



Rivet Nut Tool



1/4-20 Nuts (2)



25/64" Drill Bit

TOOLS REQUIRED:



#2 Philips Screwdriver



Marker



Drill



Rubber Mallet



7/16" Wrench



9/16" Wrench



Torque Wrench



9/16" Socket



1/8" Drill Bit



5/16" Drill Bit



Center Punch

OPTIONAL TOOL:



Tape Measure (optional)

PRE-INSTALLATION NOTE:

Make sure you have a stable, flat surface to set the cover on before installing the bin. It's possible for one person to install the bin solo, but it's much easier if you have two people.

INSTRUCTIONS

PREPARE THE COVER

Remove and Orient the Cover

1

Fold the cover and secure it folded with your cover's included straps.

2

Using a 9/16" socket wrench, remove all 4 clamps that secure your cover to your truck bed.

3

Orient the cover so the underside of the cab panel is facing up, with the notches facing you.





4

If your cover's serial number begins with 2506 or higher, look for etch marks on the flat portion of the gutter. Once located proceed to step 6. If no etch marks are visible, proceed to step 5.



Align & Mark

5

Center the bin on the cover so that the handle is facing you. Measure equal distances between the bin and the edges of the cover on both sides. The first hole in the bin's mounting bracket should be set on the flat portion of the gutter, just before the gutter's bend line. Mark only the gutter holes and then remove the bin.





TOP VIEW



SIDE VIEW

DiamondBackCovers.com / 800 935 4002

CONTINUED ON NEXT PAGE >

INSTRUCTIONS

6 Using the etch marks or marks made in step 5, center punch both marks. Using a 1/8" drill bit, drill pilot holes into the center of each previously marked point. After completing the pilot holes, switch to a 5/16" drill bit to enlarge these to their final size.

7 Put the bin on the cover, centering the bin so that the handle is facing you. Using the front most holes on the angle brackets, align them with the holes that you just drilled. Use two of the 1/4 bolts in this location to aid in alignment on the next step by inserting them through the aligned holes.

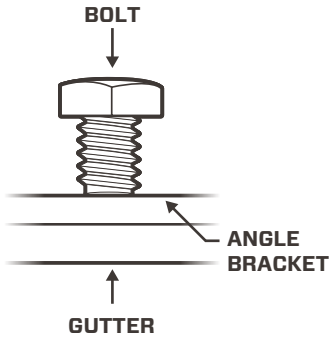
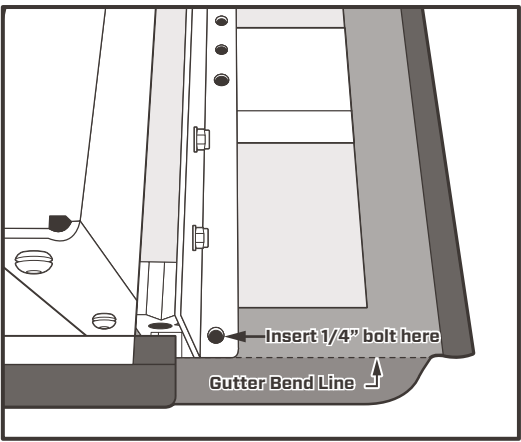

8 Using the holes in the mounting brackets as reference, mark the drilling locations on the corresponding cover points.

- For holes that correspond to the cover's studs, ensure you select and mark **only one** hole that is most centered on each stud.
- While there are multiple holes in each bracket, mark only three holes on each side, (6 in total).

NOTE: If your cover contains etch marks as described in step 4, you will only need to mark the stud holes.

! Ensure all marks are as close to the center of the hole as possible. Use a fine marker if necessary.

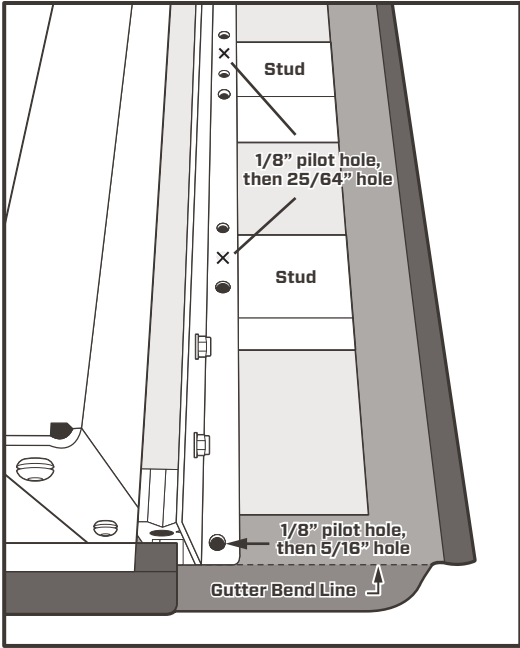
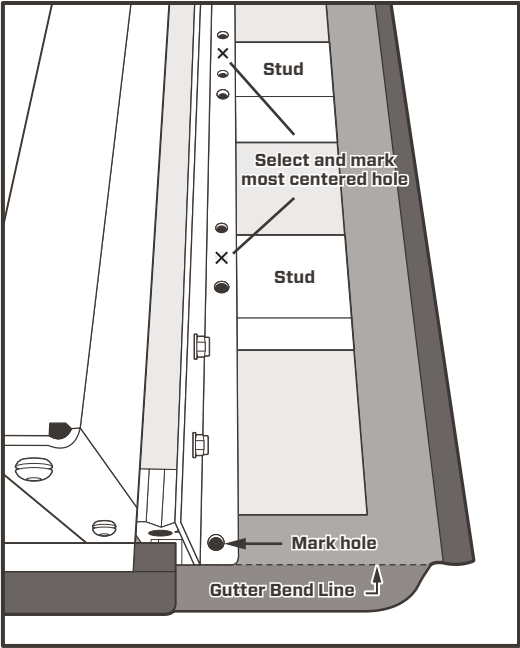

DRILL

9 After marking all four holes on the cover (two on each side) carefully remove the bin from the cover.

- Use a center punch to create an initial indentation at each marked hole to provide a starting point for the drill bit.

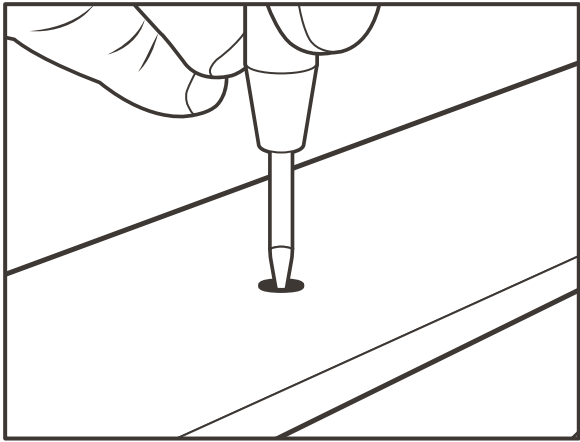

10 Using a 1/8" drill bit, drill pilot holes into the center of each previously marked point.

11 Switch to the included **25/64" drill bit** and enlarge **ONLY** the **holes in the studs** to their final size in preparation for the rivet nut installation.

! Be very careful not to drill through the exterior surface of the cover!

★ Use steady, even pressure while drilling to avoid damaging the cover. If the cover is not stable, ensure it is properly supported before drilling.

INSTALL RIVET NUTS

12 Thread a rivet nut onto the rivet nut Installation Tool. Hand tighten until the hexagonal sleeve is tight to the face of the rivet nut.

13 Using a rubber mallet, gently tap the rivet nut into the 25/64" hole.

14 Use a 9/16" wrench to hold the sleeve of the rivet nut installation tool while tightening the mandrel with a 7/16" wrench until the rivet nut deforms and locks against the interior of the stud.

- Remove the rivet nut installation tool by unscrewing the mandrel. Repeat these steps for the remaining (3) rivet nuts.

! At approximately 2 full revolutions, the Rivet Nut should be tight. **DO NOT** overtighten or you will risk stripping the Rivet Nut.

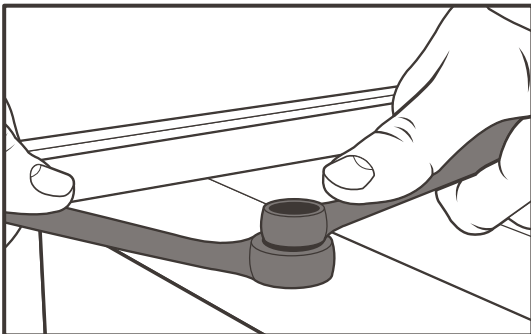
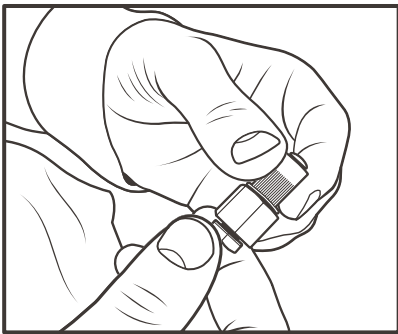
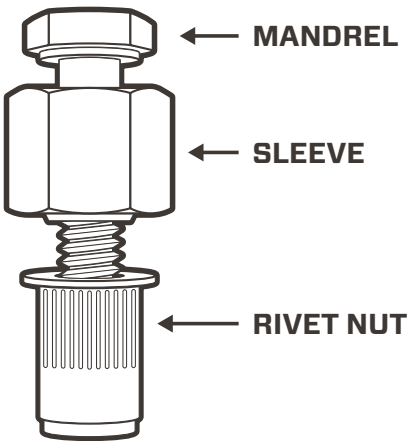

INSTRUCTIONS

SECURE THE BIN TO THE COVER

Align and Attach

- 15
- With all rivet nuts installed correctly, place the bin back on top of the cover and align the bracket holes with the newly installed rivet nuts and drilled gutter holes.

Install the Elevator Bolts

- 16
- Using a 7/16" wrench and #2 Philips Screwdriver, install an elevator bolt through the gutter, the bracket hole, lock washer, and nut at the two drilled holes in the cover's gutter.
- !
- Ensure the head of the elevator bolt is installed on the coated side of the gutter.
- 17
- Using a 7/16" wrench, tighten the bolt until secure.

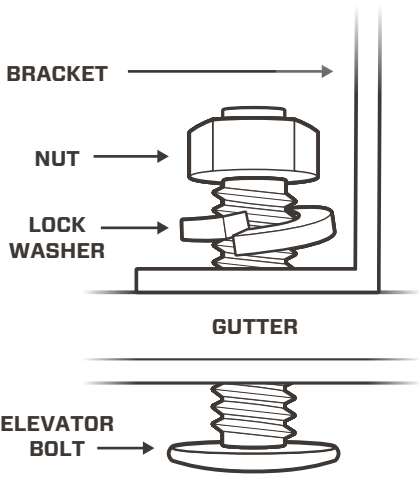
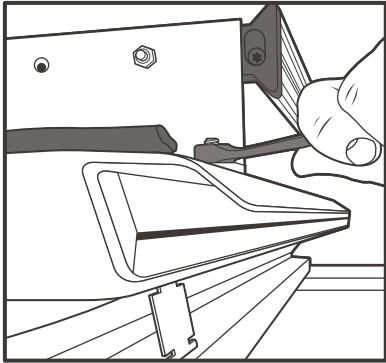
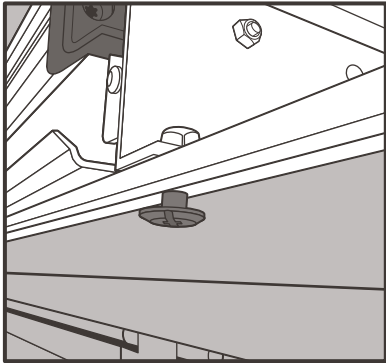

Install the Hex Bolts

- 18
- Insert a 1/4" hex bolt through a 1/4" lock washer, then through the bracket hole into the rivet nut.
- 19
- Using a 7/16" wrench, tighten the bolt until secure.
- ★
- Do not overtighten the bolts, as this may strip the rivet nuts and compromise the installation.

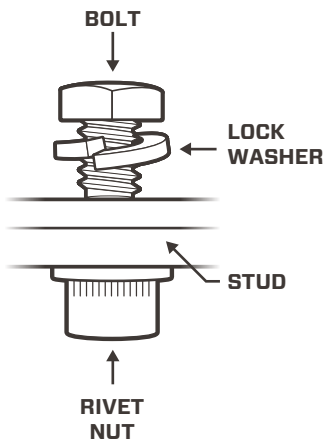
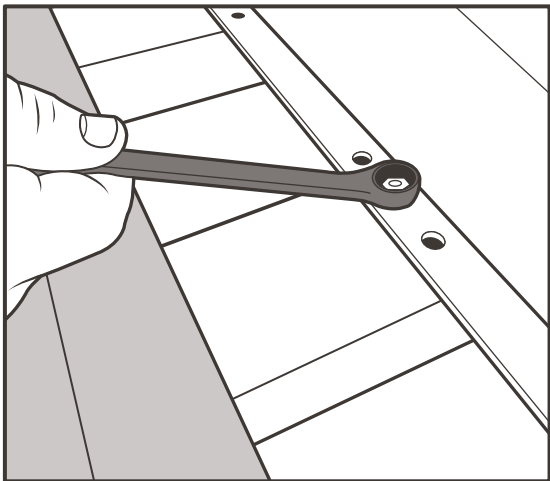

Reinstall the Cover

- 20
- With the bin securely installed, reinstall your cover in its original location using a 9/16" socket and torque to 4-5 ft-lbs.
- !
- You can fully extend the bin in order to better access the clamp locations.
- !
- If your cover's serial number begins with 2505 or lower and you are having clearance issues with the elevator bolt in the gutter, reach out to our Customer Service Team for troubleshooting by calling 800.935.4002 x2 or email support@diamondbackcovers.com.

